

# Soils Map

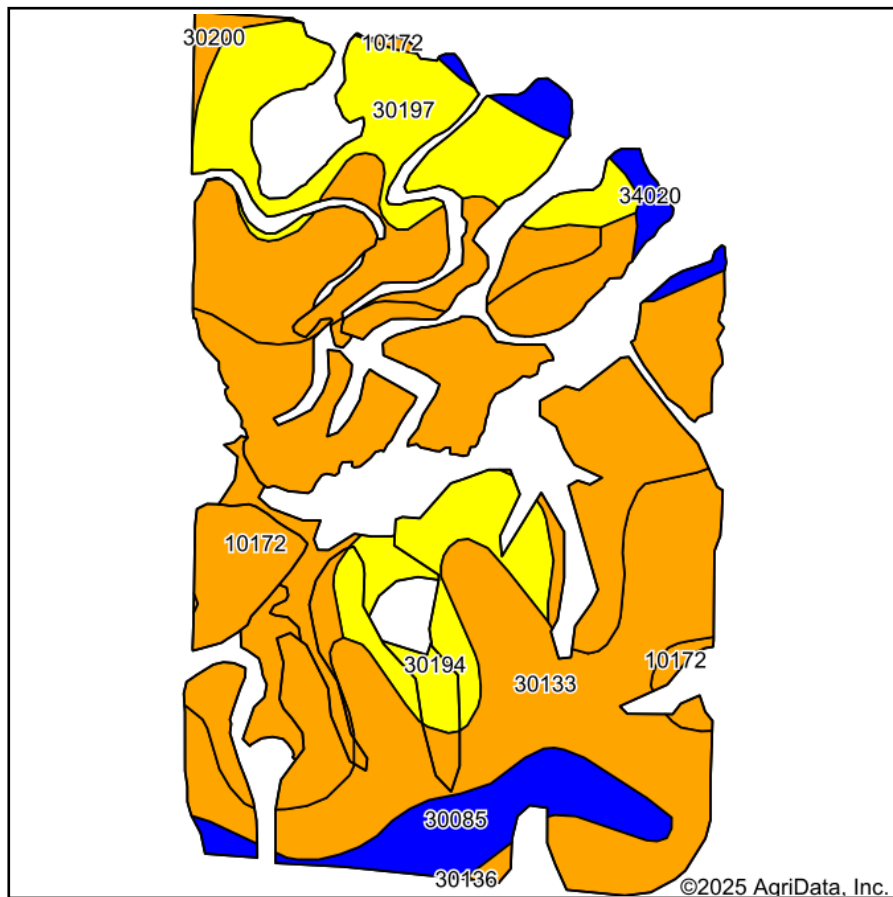

Soils data provided by USDA and NRCS.

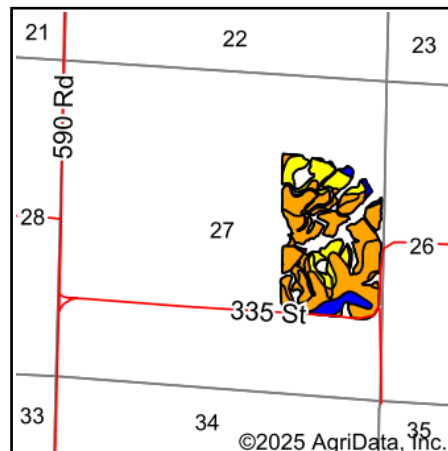

State: **Missouri**  
 County: **Gentry**  
 Location: **27-63N-30W**  
 Township: **Athens**  
 Acres: **70.79**  
 Date: **3/25/2025**



Maps Provided By:



© AgriData, Inc. 2023

www.AgriDataInc.com



Area Symbol: MO075, Soil Area Version: 27

Code	Soil Description	Acres	Percent of field	Non-Irr Class Legend	Non-Irr Class *c	Alfalfa hay Tons	Caucasian bluestem Tons	Common bermudagrass Tons	Orchardgrass red clover Tons	Tall fescue Tons	Warm season grasses Tons	*n NCCPI Overall	*n NCCPI Corn	*n NCCPI Small Grains	*n NCCPI Soy
30133	Lamoni clay loam, 5 to 9 percent slopes, eroded	25.67	36.3%		IIIe							59	59	53	
10172	Shelby clay loam, 9 to 14 percent slopes, moderately eroded	24.04	34.0%		IIIe							70	70	56	
30197	Shelby loam, 14 to 18 percent slopes	9.09	12.8%		IVe							65	65	53	
30194	Shelby clay loam, 14 to 18 percent slopes, moderately eroded	5.37	7.6%		IVe							66	66	52	
30085	Grundy silt loam, 2 to 5 percent slopes	4.54	6.4%		Ile							74	74	67	

Soils data provided by USDA and NRCS.

Code	Soil Description	Acres	Percent of field	Non-Irr Class Legend	Non-Irr Class *c	Alfalfa hay Tons	Caucasian bluestem Tons	Common bermudagrass Tons	Orchardgrass red clover Tons	Tall fescue Tons	Warm season grasses Tons	*n NCCPI Overall	*n NCCPI Corn	*n NCCPI Small Grains	*n NCCPI Soy
34020	Colo silty clay loam, drainageway, 2 to 5 percent slopes, frequently flooded	1.50	2.1%		IIw							78	78	59	
30200	Shelby loam, 9 to 14 percent slopes	0.58	0.8%		IIIe							72	72	60	
Weighted Average					3.12	*-	*-	*-	*-	*-	*-	*n 65.5	*n 65.5	*n 55	

\*n: The aggregation method is "Weighted Average using all components"

\*c: Using Capabilities Class Dominant Condition Aggregation Method