

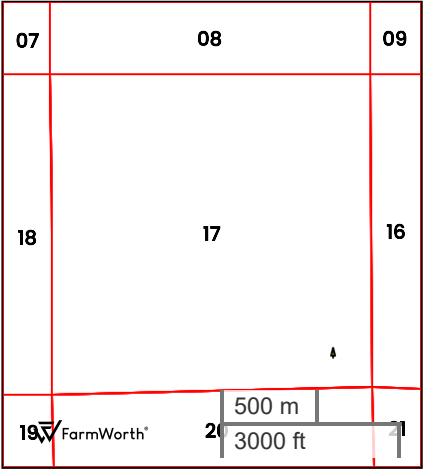

OKOBOJI BUILDING SITE  
TOTAL SOILS

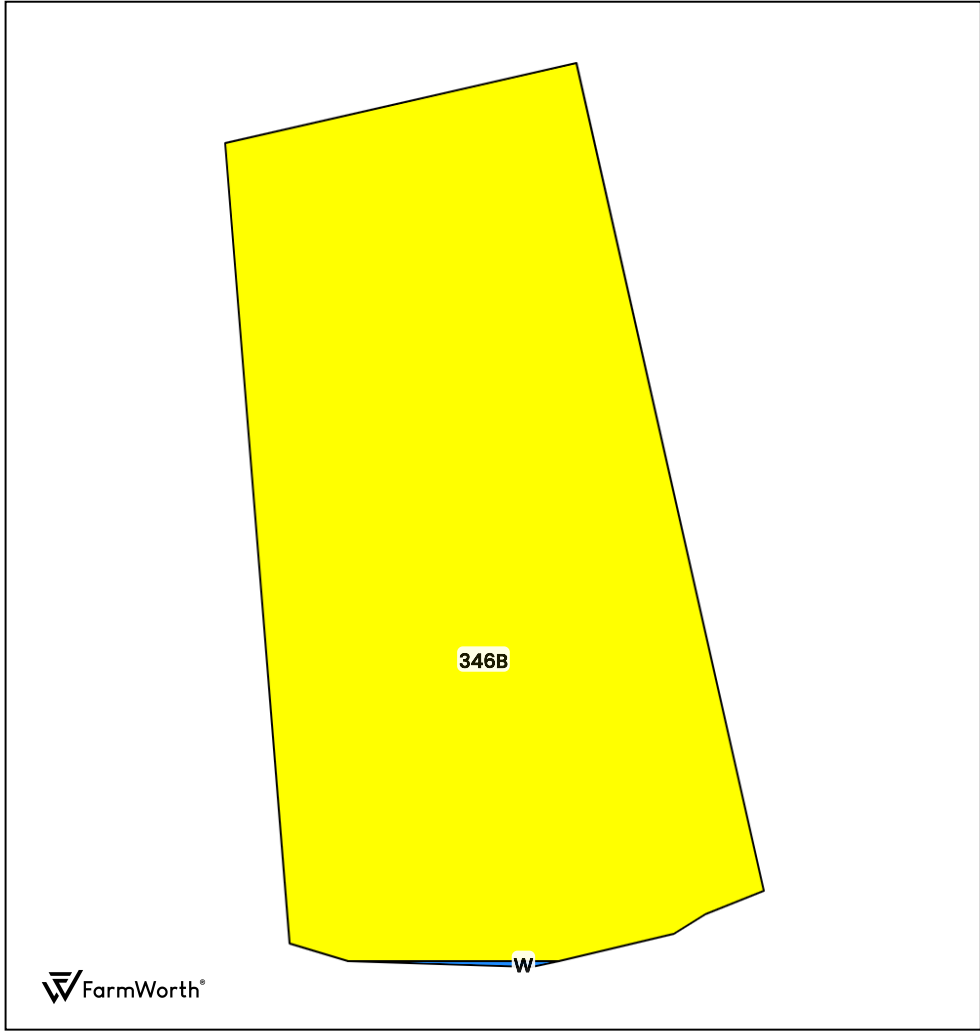

County: Dickinson County, IA  
Location: 17-99N-36W  
Township: Center Grove  
Acres: 0.19  
Date: 03/16/2025



Field borders obtained from Farm Service Agency  
as of 2008

FarmWorth, LLC makes no representations or warranties, express or implied, as to the accuracy of any information, data, numerical values, boundaries, or any other information generated through the use of FarmWorth.com. User is solely responsible for independently investigating and determining all information provided through FarmWorth.com prior to use and waives any and all claims against FarmWorth, LLC for any inaccuracies or inconsistencies in the information and/or data.

| Code     | Description   | Acres | % of field | IA CSR2 | Overall NCCPI | Soil Class (Irr) | Soil Class (Non-Irr) | Drainage Class |
|----------|---|-------|------------|---------|---------------|------------------|----------------------|----------------|
| 346B     | Augusta Lake-Estherville complex, 2 to 5 percent slopes | 0.19  | 100.00 %   | 54      | 57            | -                | 3                    | Well drained   |
| W        | Water   | 0.00  | 0.00 %     | 0       | 0             | -                | -                    | -              |
| Average: |   |       |            | 54.0    | 57.0          |                  |                      |                |

IA has updated the CSR values for each county to CSR2.  
Soils data provided by USDA and NRCS.