

Conservation Plan Map

Client(s): MARY BETH ANDREWS TRUST
Hall County, Texas
Approximate Acres: 283.80

Assisted By: CORTNEY RUIZ
MEMPHIS SERVICE CENTER
HALL-CHILDRESS SOIL & WATER CONSERVATION DISTRICT

Land Units: Tract 1466, Fields 1,10,2,3,4,7,8,9

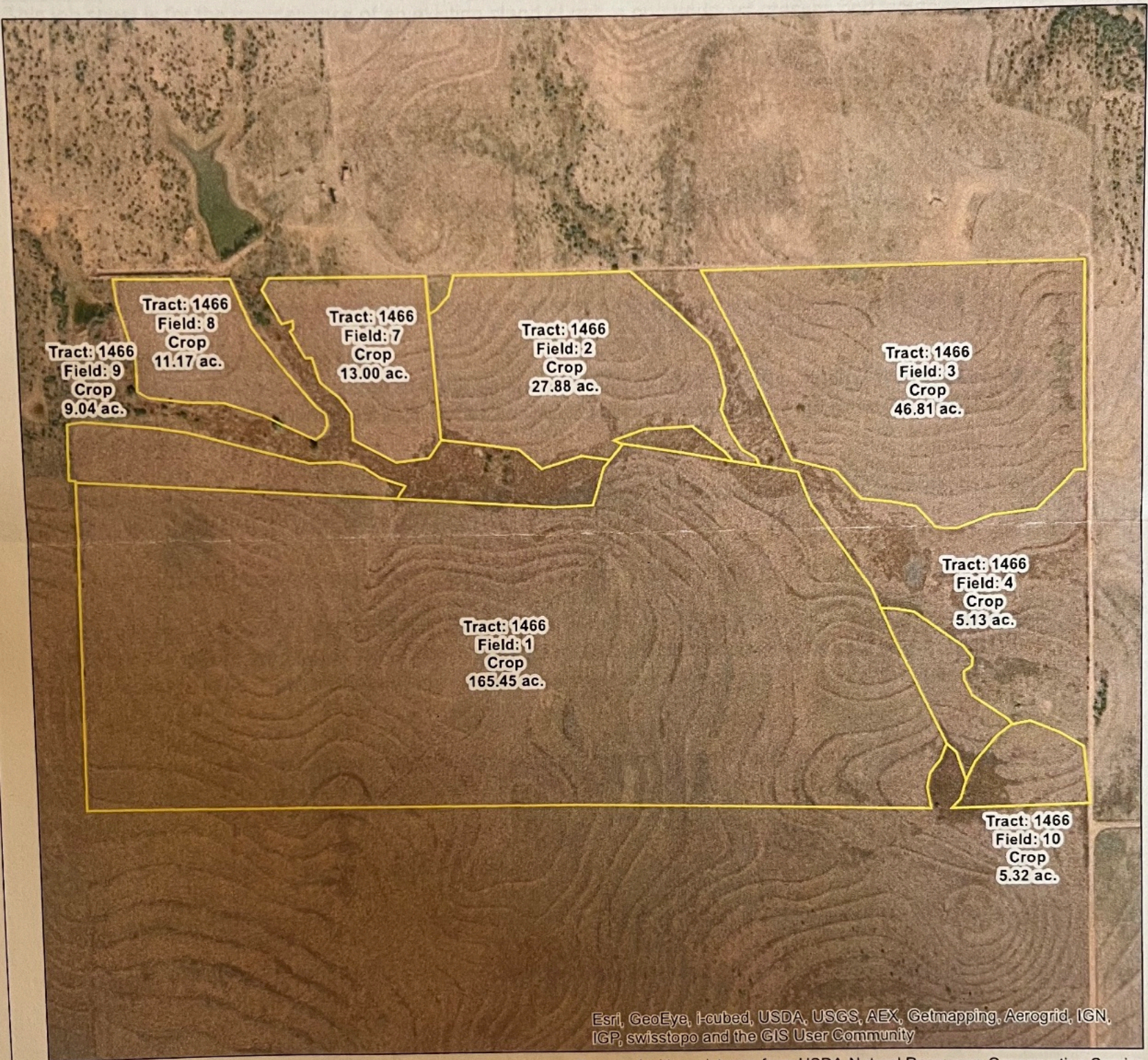

Esri, GeoEye, I-cubed, USDA, USGS, AEX, Getmapping, Aerogrid, IGN, IGP, swisstopo and the GIS User Community

Prepared with assistance from USDA-Natural Resources Conservation Service

0 752 Feet

Practice Schedule
PLUs

