

2023 Elk Unit 5

Elk Management Unit Map and Special Regulations

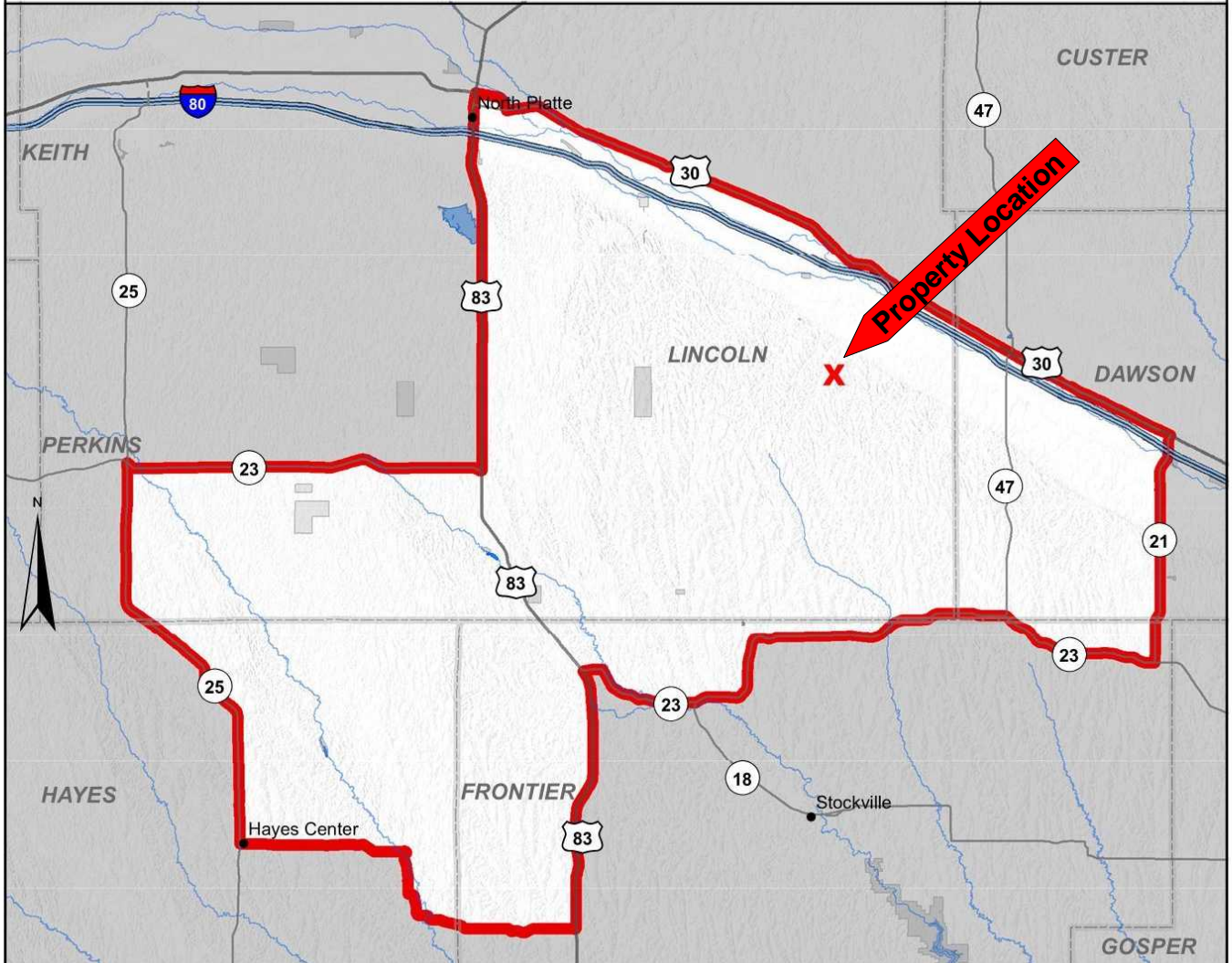

See the Elk Regulations and the Big Game Guide for additional hunting regulations. See the Public Access Atlas for regulations regarding public access areas.



Area open:

Unit 5 – Area of Nebraska included within a line commencing at the junction of U.S. Hwy 83 and U.S. Hwy 30; east to NE Hwy 21; south to NE Hwy 23; west to U.S. Hwy 83; south to County Rd 732; west to County Rd 732A; northwest to Avenue 374A; northwest to Avenue 374; north to County Rd 736A; west to County Rd 737; west to NE Hwy 25; north to NE Hwy 23; east to U.S. Hwy 83; north to the origin at U.S. Hwy 30 and as described in Unit 15 (C03.12E15).

Landowner permission required to hunt on private land. Public land restrictions may apply. State Parks, USFWS Refuges and other public lands may require access permits or have additional restrictions; contact managing agency office or see the Public Access Atlas for details.