

# Soils Map

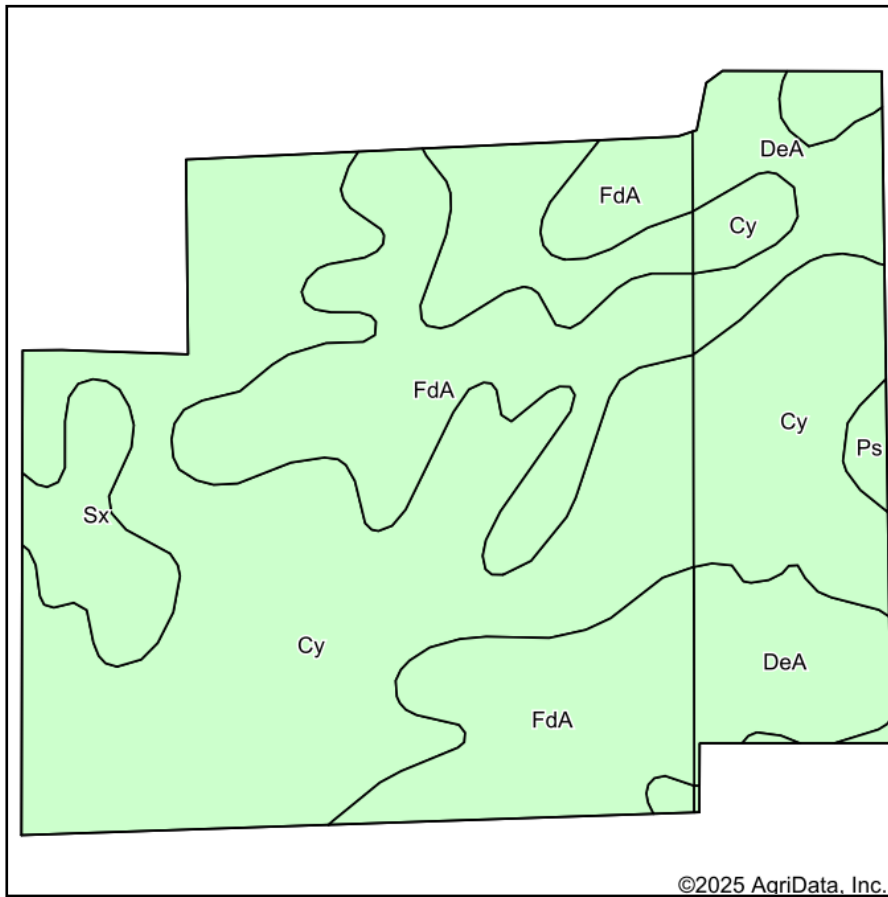

Soils data provided by USDA and NRCS.

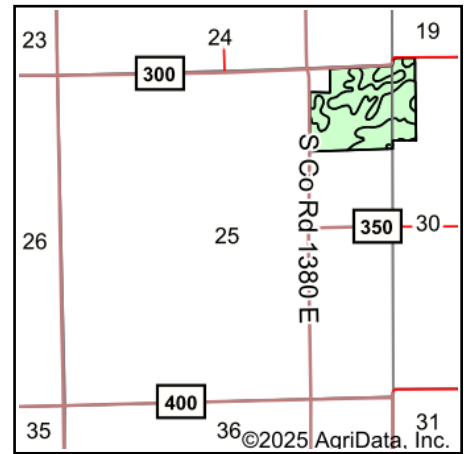

State: **Indiana**  
 County: **Clinton**  
 Location: **25-21N-2E**  
 Township: **Sugar Creek**  
 Acres: **47.99**  
 Date: **4/11/2025**



**HALDERMAN**  
 REAL ESTATE & FARM MANAGEMENT

Maps Provided By:



Area Symbol: IN023, Soil Area Version: 28  
 Area Symbol: IN159, Soil Area Version: 24

Code	Soil Description	Acres	Percent of field	Soil Drainage	Non-Irr Class *c	Corn Bu	Soybeans Bu	Winter wheat Bu
Cy	Cyclone silt loam, 0 to 2 percent slopes	21.63	45.1%	Poorly drained	IIw	185	65	75
FdA	Fincastle-Crosby silt loams, 0 to 2 percent slopes	12.94	27.0%	Somewhat poorly drained	IIw	156	51	69
Cy	Cyclone silt loam, 0 to 2 percent slopes	5.89	12.3%	Poorly drained	IIw	185	65	75
DeA	Del Rey, sandy substratum-Crosby silt loams, 0 to 2 percent slopes	5.06	10.5%	Somewhat poorly drained	IIw	127	42	57
Sx	Starks silt loam, 0 to 2 percent slopes	2.13	4.4%	Somewhat poorly drained	IIw	164	53	66
Ps	Pella, sandy substratum-Drummer, till substratum, silty clay loams	0.34	0.7%	Poorly drained	IIw	175	49	70
<b>Weighted Average</b>					<b>2.00</b>	<b>170.1</b>	<b>58.2</b>	<b>71</b>

\*c: Using Capabilities Class Dominant Condition Aggregation Method

Soils data provided by USDA and NRCS.