

Soils Map

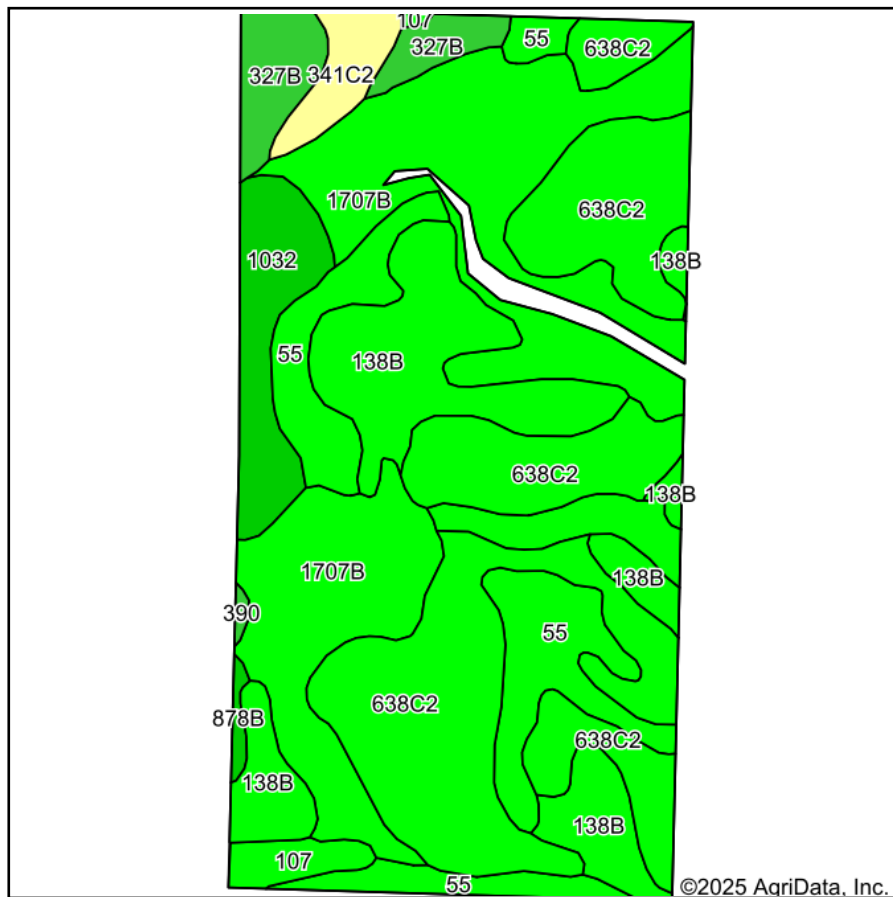

Soils data provided by USDA and NRCS.

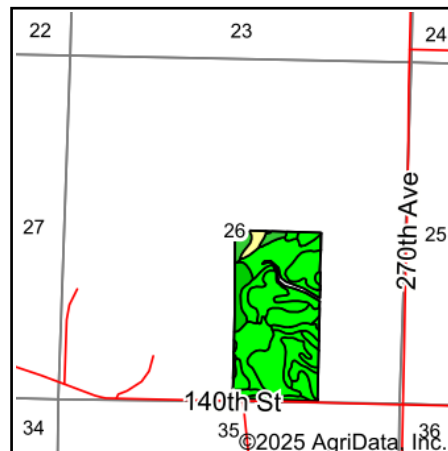

State: **Iowa**
 County: **Dickinson**
 Location: **26-100N-36W**
 Township: **Spirit Lake**
 Acres: **78.22**
 Date: **4/8/2025**

& REAL ESTATE, INC
MIDWEST LAND
 712-262-3110 MANAGEMENT
 Maps Provided By:

 CUSTOMIZED ONLINE MAPPING
 © AgriData, Inc. 2023 www.AgriDataInc.com



Area Symbol: IA059, Soil Area Version: 34

Code	Soil Description	Acres	Percent of field	CSR2 Legend	Non-Irr Class *c	CSR2**	CSR
638C2	Clarion-Storden complex, 6 to 10 percent slopes, moderately eroded	23.93	30.4%		IIIe	75	52
1707B	Delft-Terril complex, 1 to 5 percent slopes	20.63	26.4%		IIw	78	59
138B	Clarion loam, 2 to 6 percent slopes	11.98	15.3%		Ile	89	73
55	Nicollet clay loam, 1 to 3 percent slopes	11.20	14.3%		Iw	89	73
1032	Spicer silty clay loam, 0 to 2 percent slopes	4.03	5.2%		IIw	91	74
327B	Wadena-Augusta Lake-Clarion complex, 2 to 5 percent slopes	3.17	4.1%		Ile	70	55
341C2	Estherville-Pilot Grove complex, 5 to 9 percent slopes, moderately eroded	1.69	2.2%		IVe	34	19
107	Webster clay loam, 0 to 2 percent slopes	1.18	1.5%		IIw	86	70
878B	Ocheyedan loam, 2 to 5 percent slopes	0.29	0.4%		Ile	92	74
390	Waldorf silty clay loam, 0 to 2 percent slopes	0.12	0.2%		IIw	69	59
Weighted Average					2.21	79.9	61

**IA has updated the CSR values for each county to CSR2.

*c: Using Capabilities Class Dominant Condition Aggregation Method

Soils data provided by USDA and NRCS.