

Soils Map

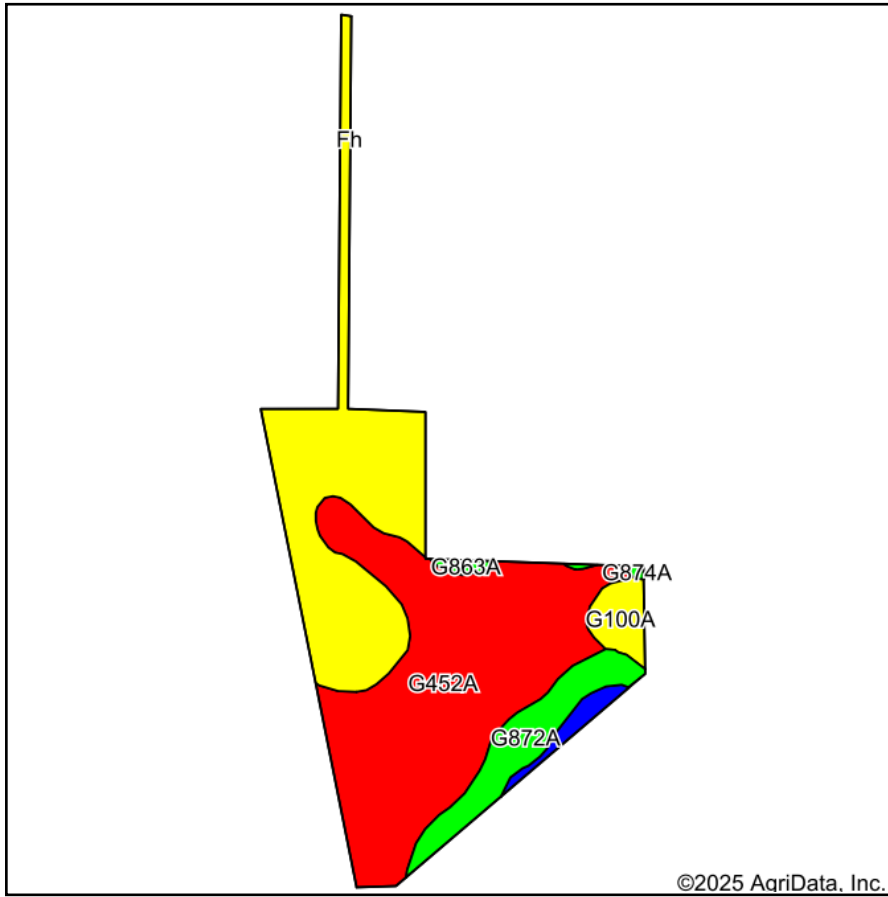

Soils data provided by USDA and NRCS.

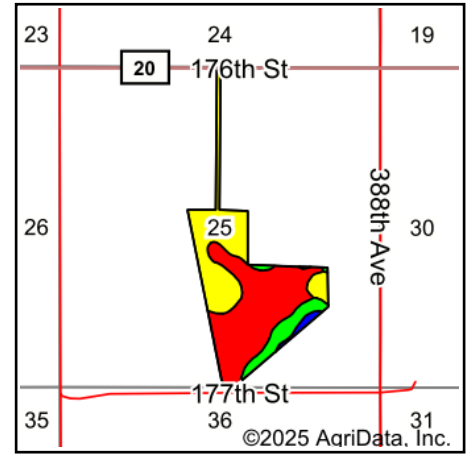

State: **South Dakota**
 County: **Spink**
 Location: **25-116N-64W**
 Township: **Redfield**
 Acres: **87**
 Date: **5/26/2025**



Maps Provided By:



Area Symbol: SD115, Soil Area Version: 25

Code	Soil Description	Acres	Percent of field	PI Legend	Non-Irr Class *c	Productivity Index	*n NCCPI Overall	*n NCCPI Corn	*n NCCPI Small Grains	*n NCCPI Soybeans
G452A	Colvin silty clay loam, saline, 0 to 1 percent slopes	44.62	51.3%		IVw	36	34	4	34	29
Fh	Forestburg-Elsmere-Toko complex, 0 to 2 percent slopes	28.59	32.9%		IVe	65	41	27	40	32
G872A	Beotia-Rondell silt loams, 0 to 2 percent slopes	8.28	9.5%		IIc	91	62	42	60	61
G100A	Hamerly-Tonka complex, 0 to 3 percent slopes	3.08	3.5%		Ile	64	51	34	48	44
G724A	Great Bend-Putney silt loams, 0 to 2 percent slopes	1.64	1.9%		IIc	87	54	34	54	51
G863A	Harmony-Beotia silt loams, till substratum, 0 to 2 percent slopes	0.66	0.8%		IIIs	92	61	45	61	61
G874A	Beotia-Winship silt loams, till substratum, 0 to 2 percent slopes	0.13	0.1%		IIc	92	64	46	64	64
Weighted Average					3.68	53.2	*n 40.2	*n 17.2	*n 39.6	*n 34.3

*n: The aggregation method is "Weighted Average using all components"

*c: Using Capabilities Class Dominant Condition Aggregation Method

Soils data provided by USDA and NRCS.