

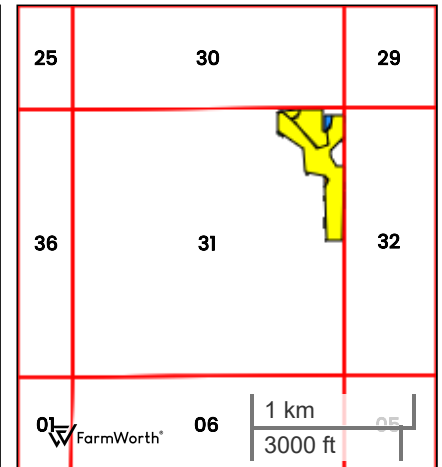

LISTING 18382
TOTAL SOILS

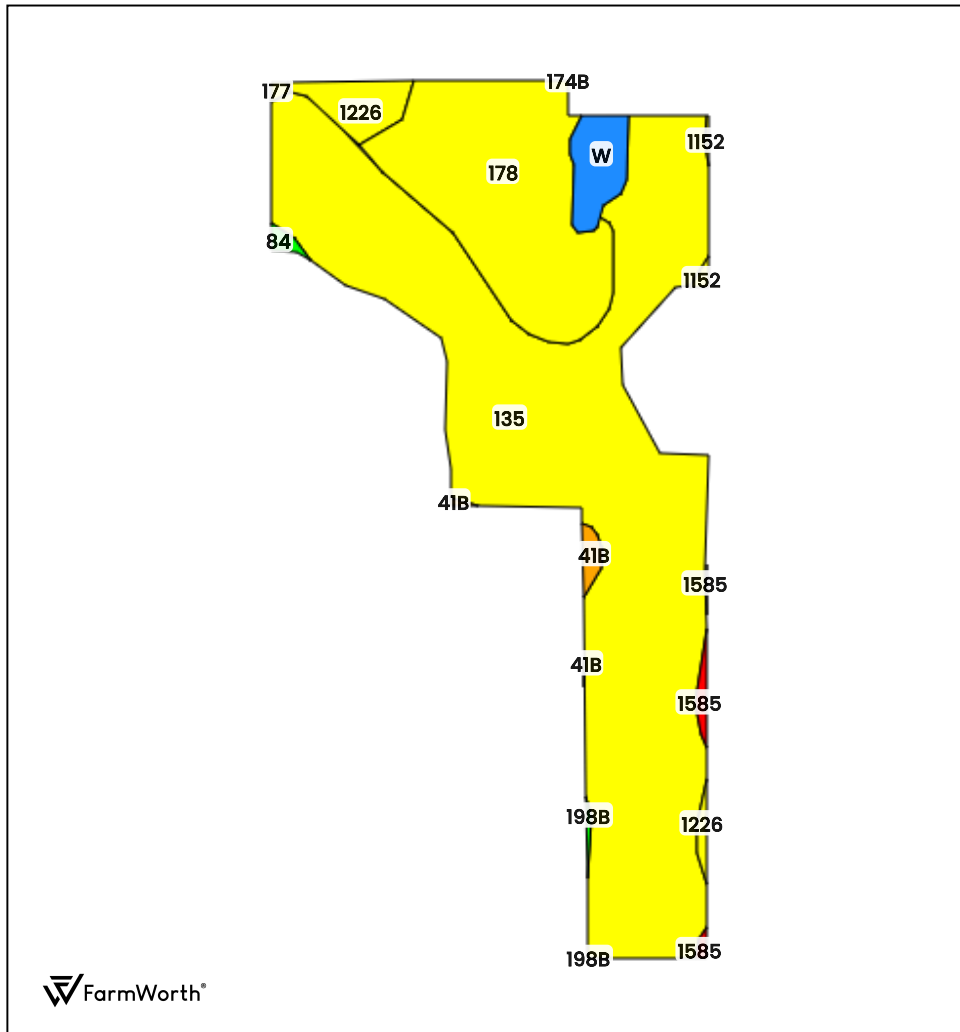

County: **Butler County, IA**
Location: **31-93N-18W**
Township: **Bennezette**
Acres: **36.98**
Date: **05/27/2025**



Field borders obtained from Farm Service Agency
as of 2008

FarmWorth, LLC makes no representations or warranties, express or implied, as to the accuracy of any information, data, numerical values, boundaries, or any other information generated through the use of FarmWorth.com. User is solely responsible for independently investigating and determining all information provided through FarmWorth.com prior to use and waives any and all claims against FarmWorth, LLC for any inaccuracies or inconsistencies in the information and/or data.

Code	Description	Acres	% of field	IA CSR2	Soil Class (Non-Irr)
135	Coland clay loam, 0 to 2 percent slopes, occasionally flooded	26.41	71.42 %	65	2
178	Waukee loam, 0 to 2 percent slopes	7.70	20.82 %	69	2
1226	Lawler loam, 0 to 2 percent slopes, rarely flooded	1.07	2.89 %	59	2
W	Water	1.07	2.89 %	0	-
41B	Sparta loamy sand, 2 to 5 percent slopes	0.23	0.62 %	42	4
1585	Spillville-Coland complex, 0 to 2 percent slopes, frequently flooded	0.21	0.57 %	22	5
84	Clyde silty clay loam, 0 to 3 percent slopes	0.10	0.27 %	88	2
1152	Marshan clay loam, 0 to 2 percent slopes, rarely flooded	0.08	0.22 %	54	2
177	Saude loam, 0 to 2 percent slopes	0.06	0.16 %	60	2
198B	Floyd loam, 1 to 4 percent slopes	0.05	0.14 %	89	2
174B	Bolan loam, 2 to 5 percent slopes	0.00	0.00 %	64	2
Average:				63.5	

IA has updated the CSR values for each county to CSR2.
Soils data provided by USDA and NRCS.