

**LEGEND**

- = BOUNDARY LINE
- = ADJACENT LOT LINES
- F.I.P. = FOUND IRON PIPE
- F.R. = FOUND REBAR
- S.I.P. = SET 1-1/4" IRON PIPE W/ PS #1637 CAP
- S.R. = SET REBAR W/ PS #1637 CAP

PART SW1/4, SW1/4 SECTION 9-T11N-R4E POINSETT CO., AR (NOT INCLUDED)

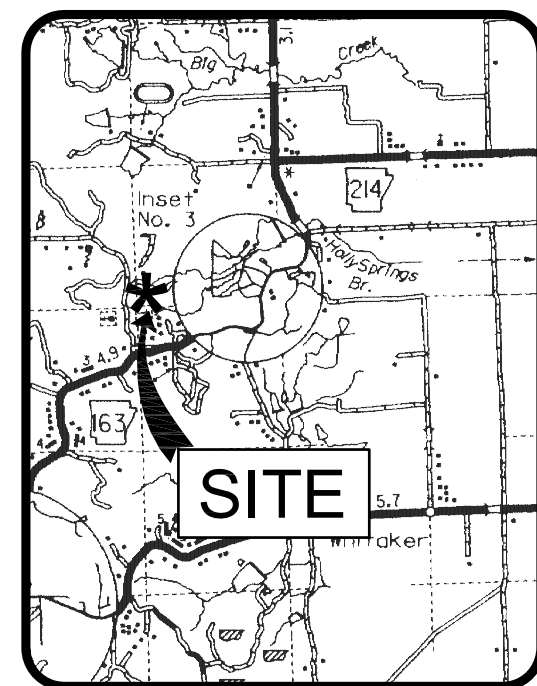
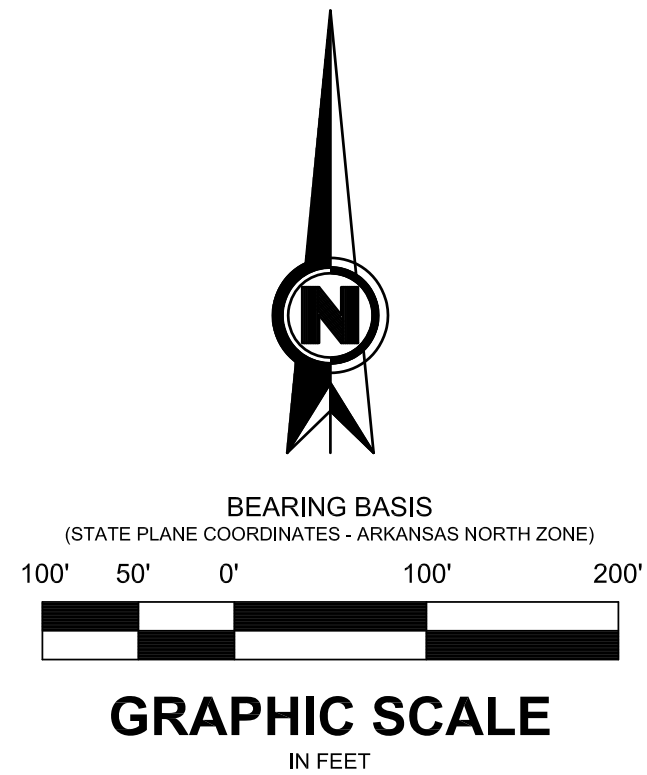

**DESCRIPTION - TRACT 1**

A PART OF THE SOUTHWEST QUARTER OF THE SOUTHWEST QUARTER OF SECTION 9, TOWNSHIP 11 NORTH, RANGE 4 EAST, POINSETT COUNTY, ARKANSAS, BEING MORE PARTICULARLY DESCRIBED AS FOLLOWS:

BEGINNING AT THE SOUTHWEST CORNER OF SECTION 9, AFORESAID; THENCE NORTH 00°13'30" WEST, A DISTANCE OF 1,015.76 FEET TO A POINT; THENCE SOUTH 87°16'20" EAST, A DISTANCE OF 95.78 FEET TO A POINT; THENCE SOUTH 19°56'17" EAST, A DISTANCE OF 324.08 FEET TO A POINT; THENCE SOUTH 09°42'12" EAST, A DISTANCE OF 213.15 FEET TO A POINT; THENCE SOUTH 00°13'30" EAST, A DISTANCE OF 494.69 FEET TO A POINT; THENCE SOUTH 89°34'56" WEST, A DISTANCE OF 240.07 FEET TO THE POINT OF BEGINNING.

CONTAINING IN ALL 211,735 SQ. FT. OR 4.86 ACRES, MORE OR LESS.

SUBJECT TO EASEMENTS, RESTRICTIONS, RESERVATIONS AND RIGHTS-OF-WAY OF RECORD.

**DESCRIPTION - TRACT 2**

A PART OF THE SOUTHWEST QUARTER OF THE SOUTHWEST QUARTER OF SECTION 9, TOWNSHIP 11 NORTH, RANGE 4 EAST, POINSETT COUNTY, ARKANSAS, BEING MORE PARTICULARLY DESCRIBED AS FOLLOWS:

COMMENCING AT THE SOUTHWEST CORNER OF SECTION 9, AFORESAID; THENCE NORTH 89°34'56" EAST, A DISTANCE OF 240.07 FEET TO THE POINT OF BEGINNING; THENCE NORTH 00°13'30" WEST, A DISTANCE OF 494.69 FEET TO A POINT; THENCE NORTH 09°42'12" WEST, A DISTANCE OF 213.15 FEET TO A POINT; THENCE NORTH 19°56'17" WEST, A DISTANCE OF 324.08 FEET TO A POINT; THENCE SOUTH 87°16'20" EAST, A DISTANCE OF 69.43 FEET TO A POINT; THENCE SOUTH 70°49'44" EAST, A DISTANCE OF 221.27 FEET TO A POINT; THENCE SOUTH 00°13'30" EAST, A DISTANCE OF 76.01 FEET TO A POINT LYING ON THE CENTERLINE OF MARPLE ROAD; THENCE SOUTH 18°00'59" EAST, DEPARTING SAID CENTERLINE, A DISTANCE OF 456.66 FEET TO A POINT; THENCE SOUTH 00°13'30" EAST, A DISTANCE OF 421.21 FEET TO A POINT; THENCE SOUTH 89°34'56" WEST, A DISTANCE OF 273.17 FEET TO THE POINT OF BEGINNING.

CONTAINING IN ALL 246,617 SQ. FT. OR 5.66 ACRES, MORE OR LESS.

SUBJECT TO EASEMENTS, RESTRICTIONS, RESERVATIONS AND RIGHTS-OF-WAY OF RECORD.

**DESCRIPTION - TRACT 3**

A PART OF THE SOUTHWEST QUARTER OF THE SOUTHWEST QUARTER OF SECTION 9, TOWNSHIP 11 NORTH, RANGE 4 EAST, POINSETT COUNTY, ARKANSAS, BEING MORE PARTICULARLY DESCRIBED AS FOLLOWS:

COMMENCING AT THE SOUTHWEST CORNER OF SECTION 9, AFORESAID; THENCE NORTH 89°34'56" EAST, A DISTANCE OF 513.24 FEET TO THE POINT OF BEGINNING; THENCE NORTH 00°13'30" WEST, A DISTANCE OF 421.21 FEET TO A POINT; THENCE NORTH 18°00'59" WEST, A DISTANCE OF 456.66 FEET TO A POINT LYING ON THE CENTERLINE OF MARPLE ROAD; THENCE SOUTH 58°23'05" EAST, ALONG SAID CENTERLINE, A DISTANCE OF 124.05 FEET TO A POINT; THENCE SOUTH 62°32'49" EAST, CONTINUING ALONG SAID CENTERLINE, A DISTANCE OF 242.13 FEET TO A POINT; THENCE SOUTH 72°52'30" EAST, CONTINUING ALONG SAID CENTERLINE, A DISTANCE OF 109.14 FEET TO A POINT; THENCE SOUTH 00°13'30" EAST, DEPARTING SAID CENTERLINE, A DISTANCE OF 646.32 FEET TO A POINT; THENCE SOUTH 89°34'56" WEST, A DISTANCE OF 279.05 FEET TO THE POINT OF BEGINNING.

CONTAINING IN ALL 220,442 SQ. FT. OR 5.06 ACRES, MORE OR LESS.

SUBJECT TO EASEMENTS, RESTRICTIONS, RESERVATIONS AND RIGHTS-OF-WAY OF RECORD.

**DESCRIPTION - TRACT 4**

A PART OF THE SOUTHWEST QUARTER OF THE SOUTHWEST QUARTER OF SECTION 9, TOWNSHIP 11 NORTH, RANGE 4 EAST, POINSETT COUNTY, ARKANSAS, BEING MORE PARTICULARLY DESCRIBED AS FOLLOWS:

COMMENCING AT THE SOUTHWEST CORNER OF SECTION 9, AFORESAID; THENCE NORTH 89°34'56" EAST, A DISTANCE OF 792.29 FEET TO THE POINT OF BEGINNING; THENCE NORTH 00°13'30" WEST, A DISTANCE OF 646.32 FEET TO A POINT LYING ON THE CENTERLINE OF MARPLE ROAD; THENCE SOUTH 72°52'30" EAST, ALONG SAID CENTERLINE, A DISTANCE OF 109.14 FEET TO THE POINT OF CURVATURE OF A CURVE CONCAVE TO THE NORTHEAST, HAVING A RADIUS OF 203.54 FEET, A CENTRAL ANGLE OF 68°13'07"; A CHORD BEARING OF NORTH 73°37'57" EAST AND A CHORD DISTANCE OF 228.28 FEET; THENCE NORTHEASTERLY ALONG THE ARC OF SAID CURVE AND CONTINUING ALONG SAID CENTERLINE, A DISTANCE OF 149.29 FEET TO THE POINT OF TANGENCY OF SAID CURVE; THENCE NORTH 36°54'23" EAST, CONTINUING ALONG SAID CENTERLINE, A DISTANCE OF 67.99 FEET TO A POINT; THENCE SOUTH 00°40'16" WEST, DEPARTING SAID CENTERLINE, A DISTANCE OF 730.35 FEET TO A POINT; THENCE SOUTH 89°34'56" WEST, A DISTANCE OF 353.07 FEET TO THE POINT OF BEGINNING.

CONTAINING IN ALL 226,265 SQ. FT. OR 5.19 ACRES, MORE OR LESS.

SUBJECT TO EASEMENTS, RESTRICTIONS, RESERVATIONS AND RIGHTS-OF-WAY OF RECORD.

**SURVEYOR'S NOTES**

1. THIS BOUNDARY SURVEY WAS PREPARED FOR KLM LAND, LLC.
2. NO SEARCH OF THE PUBLIC RECORDS HAS BEEN MADE BY THIS SURVEYOR FOR EASEMENTS, RESTRICTIONS, RESERVATIONS OR RIGHTS-OF-WAY AFFECTING THIS PROPERTY.
3. THE FOLLOWING DOCUMENTS WERE USED TO PREPARE THIS SURVEY:
  - A. WARRANTY DEED TO DAVID AND DEBBIE HARTSHORN, DATED 01/31/2014, AS RECORDED IN DEED BOOK 2014, PAGE 368, PUBLIC RECORDS OF POINSETT COUNTY, AT HARRISBURG, ARKANSAS.
  - B. SURVEY PREPARED BY HERBERT HIME, PS#1142, DATED 01/14/2014, RECORDED AT THE STATE SURVEYOR'S OFFICE AS DOCUMENT #201402060042 IN LITTLE ROCK, ARKANSAS.
  - C. SURVEY PREPARED BY HERBERT HIME, PS #1142, DATED 02/12/2023, RECORDED AT THE STATE SURVEYOR'S OFFICE AS DOCUMENT #202303076138 IN LITTLE ROCK, ARKANSAS.
  - D. POINSETT COUNTY QUORUM COURT EMERGENCY ORDINANCE NO. 2015-10, DATED JUNE 8, 2015.

**SURVEYOR'S CERTIFICATION**

I HEREBY CERTIFY THAT BENCHMARK LAND SURVEYING, INC. HAS THIS DATE MADE A BOUNDARY SURVEY OF THE ABOVE DESCRIBED PROPERTY AS SHOWN HEREON AND THAT SAID SURVEY IS ACCURATE AND CORRECT TO THE BEST OF MY KNOWLEDGE AND BELIEF. THERE ARE NO APPARENT ABOVE GROUND ENCROACHMENTS OTHER THAN AS SHOWN OR STATED HEREON AND THAT THIS SURVEY WAS MADE IN ACCORDANCE WITH THE ARKANSAS MINIMUM STANDARDS FOR PROPERTY SURVEYS AND PLATS IN EFFECT ON THIS DATE.

DATE OF BOUNDARY SURVEY: 07/24/2025

**BENCHMARK LAND SURVEYING, INC.**  
LAND SURVEYING - CONSTRUCTION LAYOUT SERVICES  
2500 ALEXANDER DR., SUITE A  
P.O. BOX 1921 - JONESBORO, AR 72403  
FAX: 870-336-2060 PH: 870-336-2059

**BOUNDARY SURVEY**

**KLM LAND, LLC**

**A PART OF THE SW1/4, SW1/4 SECTION 9 - T11N - R4E POINSETT COUNTY, ARKANSAS**

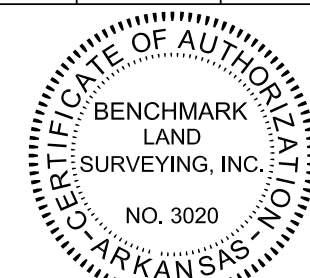

BENCHMARK LAND SURVEYING, INC.  
ARKANSAS C.O.A. #3020

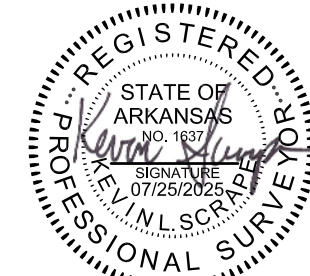

DATE:	BY:	DESCRIPTION:

500-11N-04E-0-09-330-56-1637

CADD FILE: 25231-001 SCALE: 1"=100'

DATE: 07/25/2025 DRAWN BY: AJ

DWG#: 0411091-0001 SHEET: 1 OF 1