

Soils Map

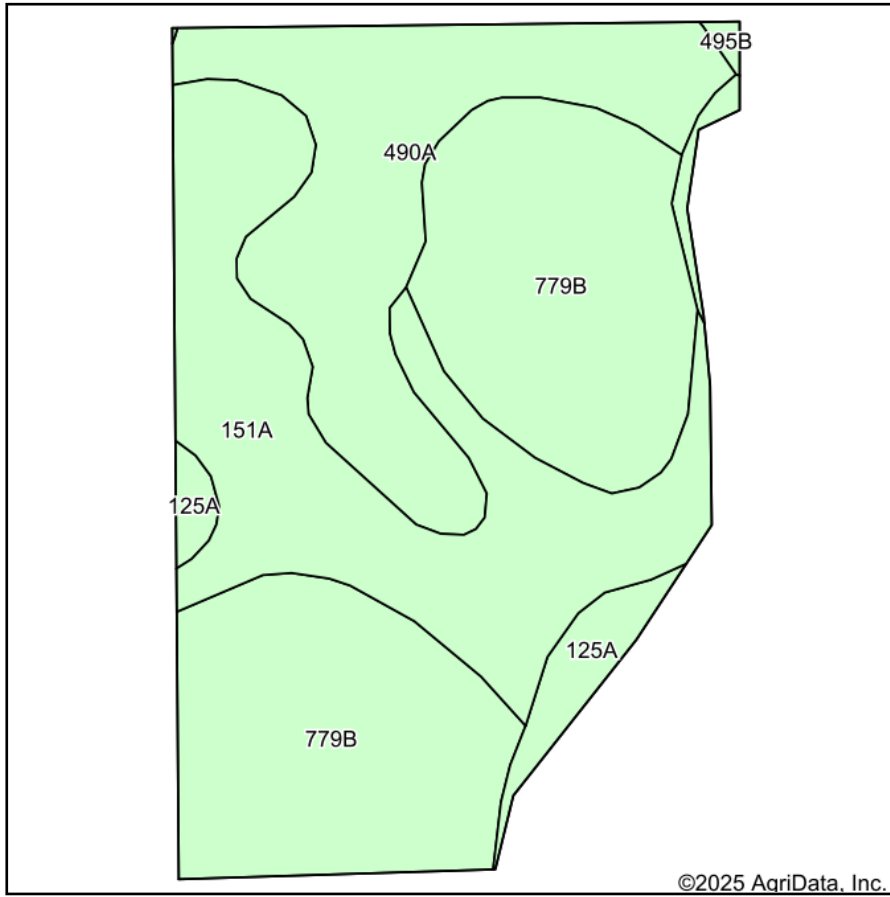

Soils data provided by USDA and NRCS.

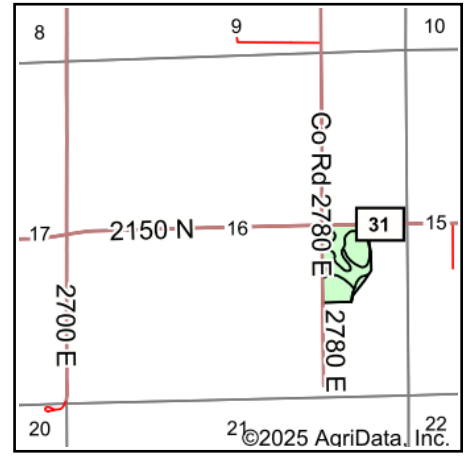

State: **Illinois**
 County: **Iroquois**
 Location: **16-27N-11W**
 Township: **Concord**
 Acres: **19.24**
 Date: **4/3/2025**

GESWEIN
FARM & LAND

Maps Provided By:

 CUSTOMIZED ONLINE MAPPING
 © AgriData, Inc. 2023 www.AgriDataInc.com



Area Symbol: IL075, Soil Area Version: 18

Code	Soil Description	Acres	Percent of field	Water Table	Subsoil rooting a	Corn Bu/A	Soybeans Bu/A	Crop productivity index for optimum management	*n NCCPI Overall	*n NCCPI Corn	*n NCCPI Soybeans
**779B	Chelsea loamy fine sand, 1 to 6 percent slopes	8.17	42.5%	> 6.5ft.	FAV	**103	**32	**75	47	47	29
**151A	Ridgeville fine sandy loam, 0 to 2 percent slopes	5.64	29.3%	1.5ft.	FAV	**151	**51	**114	76	76	62
490A	Odell silt loam, 0 to 2 percent slopes	4.53	23.5%	1.5ft.	FAV	176	56	129	71	68	71
**125A	Selma loam, 0 to 2 percent slopes	0.90	4.7%	0.5ft.	FAV	**176	**57	**129	77	75	77
Weighted Average						137.7	44.4	101.7	*n 62.6	*n 61.8	*n 50.8

Table: Optimum Crop Productivity Ratings for Illinois Soil EFOTG are sourced from Bulletin 811 calculated Map Unit Base Yield Indices, and adjusted (Adj) for slope, erosion, flooding, and surface texture. Publication Date: 01-28-2025

Crop yields and productivity (B811 EFOTG) are maintained at the following USDA web site: 2023 Illinois Soil Productivity and Yield Indices: <https://efotg.sc.egov.usda.gov/#/state/IL/documents/section=2&folder=52809>

** Base indexes from Bulletin 811 adjusted for slope, erosion, flooding, and surface texture according to the Il. Soils EFOTG

*n: The aggregation method is "Weighted Average using all components"